



Exam Site Information for Candidates

~

March 30, 2019

DSU | COLLEGE OF HEALTH SCIENCES
DIXIE STATE UNIVERSITY | **DENTAL HYGIENE**

TAYLOR HEALTH SCIENCES CENTER

ST. GEORGE, UTAH 84790

(435) 879-4900

Information for Candidates

Table of Contents

Testing Location & Directions	3
Mailing Address	3
Clinic Address	3
Driving Directions to the Clinic	3
Telephone Numbers.....	3
Parking & Clinic Entrance	4
Clinic Floor Plan.....	5
Preparing for the Exam	6
Patient Screening	6
Radiographs	6
Administration of Local Anesthetic	6
Equipment, Instruments & Expendable Dental Materials	6
Sterilization Services	7
During the Clinical Exam	8
Dental Operatory Units	8

Testing Location & Directions

Mailing Address

DSU Dental Hygiene
225 South University Avenue
St George, UT 84770

Clinic Address

DSU Dental Hygiene Clinic
Taylor Health Sciences Center
1526 E Medical Center Drive
St. George, Utah 84790



Click on [map](#) for larger view.

Driving Directions to the Clinic

- At **EXIT 8**, take ramp for I-15 **St George Boulevard**
- Turn **LEFT** onto UT-34 E / E St George Blvd
- Turn **RIGHT** onto River Rd. You will **pass Target and Lowes** on the left-hand side.
- Turn **LEFT** onto **E Medical Center Drive / E 480 South**
- Pass Intermountain Dixie Regional Medical Center and Jubilee Home II on the right-hand side.
- Turn **RIGHT** into the DSU Taylor Health Sciences Center parking lot.
- Park and enter on the **SOUTHEAST SIDE** at the Dental Hygiene Clinic Entrance.

Telephone Numbers

(435) 879-4900	Clinic Manager: Elyse Perkins
(435) 879-4905	Secretary: Rachel Christ
(435) 879-4904	Department Chair: Patricia Wintch, MSDH

Parking & Clinic Entrance

- Enter the Clinic on the South Side of the Taylor Health Science Center
- **Free parking** for Candidates and Patients allowed in any part of the parking lot located at the Russell Taylor Health Science Building.
- Permits are not required during CDCA examination days and parking lot hours are 6:00 a.m. to 6:00 p.m.
- Vehicles left after hours on campus are subject to being towed.



Click on [map](#) for larger view.

Clinic Floor Plan

Patient waiting area, Candidate clinic, Examiner grading area, areas of emergency equipment: **Please see attached map**

- **Blue line** represents barrier curtains.
- Operatories on the right side of the blue line are the **examiner area**.
- Operatories on the left side of the blue line are **candidate operatories**.
- **Patient reception room** is located on the far left lower corner.
- The hallway located just outside the top of the map is the **check-in area**.
- **Blue star** notes location of emergency binder, emergency first aid kit and emergency oxygen.
- **Red lightning bolt** notes location of the AED unit.

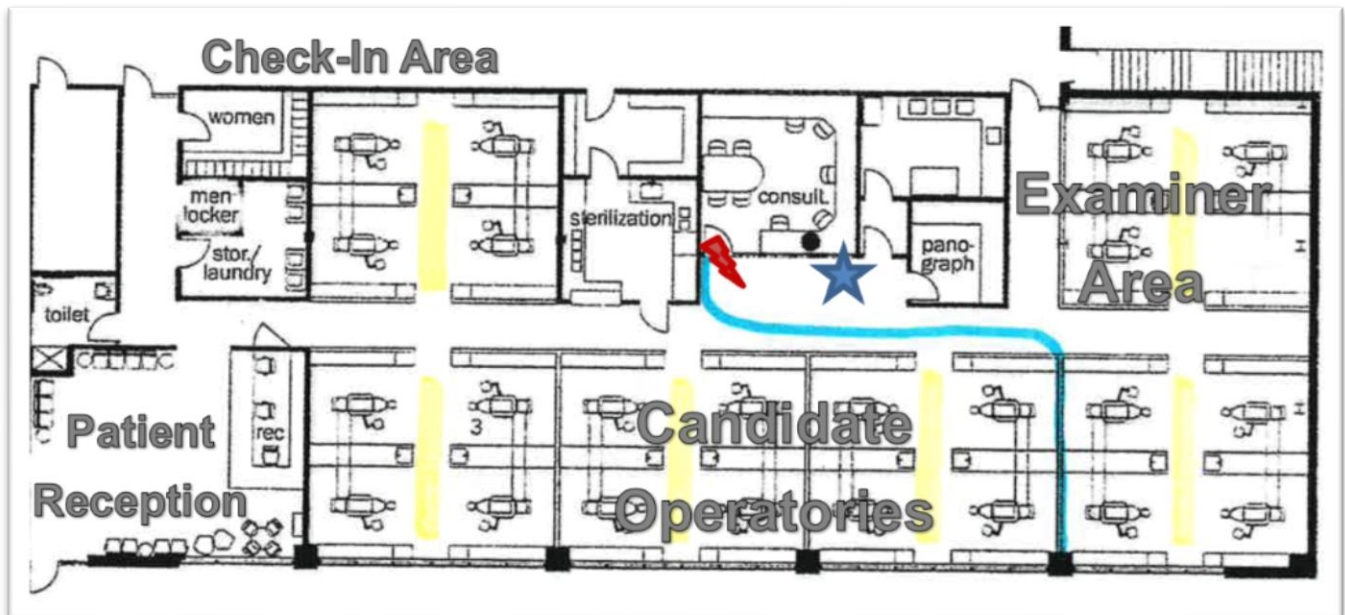

Preparing for the Exam

Patient Screening: Dixie State University Dental Hygiene Clinic will be available for patient screenings for out-of-town candidates **March 29, 2019 from 5:00pm to 7:00pm.**

Radiographs: In the event that a candidate needs radiographs taken, an x-ray machine will be available along with assistance with the software. A digital full mouth set of images may be purchased for \$30. **All fees must be paid in cash. No credit cards or checks are accepted.**

Administration of Local Anesthetic: A qualified, licensed practitioner will be available to administer local anesthetic to Candidate Patients during the exam for \$20.00 per patient, cash only.

Equipment, Instruments & Expendable Dental Materials: Refer to the respective WREB Candidate Guide for a list of materials and armamentarium that the Candidate must provide.

- **Handpiece and Prophy Angle Hookups:** The DSU Dental Hygiene clinic has standard slow speed handpiece hookups. Slow speed handpieces are available to rent for \$30.00. Cash only. No high speed handpieces will be available. One week advance notification is required. Please call (435) 879-4900.
- **Sonic/Ultrasonic Devices:** All operatories have Dentsply Cavitrons available. Ultrasonic handpieces are available for rent for \$30.00 cash. Ultrasonic inserts are not available for rent. Candidates should plan to bring their own. Should a candidate desire to use their own ultrasonic, all operatories are equipped with a standard “quick connect” water hookup. Adapters are available. One week notice required for ultrasonic handpieces.

- **Air/Water Syringe Tips:** Syringe tips are disposable and available at no charge.
- **Blood Pressure Cuffs and Stethoscopes:** Candidates should bring their own blood pressure cuffs and stethoscopes.
- **Expendable Materials:** Expendable dental materials supplied by the school are noted below. (Items not listed are responsibility of Candidate).

Expendable Dental Hygiene Materials List		
2x2 gauze squares	Cotton-tip applicators	Patient bib clips, disposable
Air/water syringe tips	Drinking cups	Patient napkins/bibs
Antimicrobial mouthwash	Face masks	Prophy paste
Anesthetic(s)	Facial tissue	Sanitizing materials
Local anesthetic(s)	Gloves	Soap
Topical anesthetic(s)	Gloves, non-latex (S,M,L,XL)	Standard saliva ejectors
Autoclave bags, small	Overgloves	Surface disinfectant
Autoclave bags, medium	Headrest covers	Tray covers
Autoclave tape	Instrument trays, disposable	Trash bags
Barrier covers/tape	Paper towels	

Sterilization Services: Should candidates require instrument sterilization; an assistant will be available between **4:30pm and 6:30pm March 29, 2019** to sterilize instruments for the following day's test. Sterilization will not be available following the test. Appropriate containers should be brought with the candidates for carrying out soiled instruments following the examination. **Candidates retaking onsite will need their instruments sterilized prior to retake clinic entrance.**

During the Clinical Exam

Dental Operatory Units: All operatories are equipped with Belmont chairs, BDS 0020 and delivery control Belmont X-Calibur 2575.

Infection Control (Surface Asepsis):

- Each candidate will be expected to clean her/his operatory area following the examination. Candidates will be given a packet of barriers to reset the area for the following candidate.
- All barriers, eye protection, masks and gloves are required during cleaning tasks.
- Sprays will not be used in the immediate clinic area. Disinfection of clinic surfaces is to be performed using pre-moistened *Sani-cloths* located in the cabinet underneath the sink.
- Please clean up any disclosing solution spills or shoe scuff marks from the floors when cleaning. Cleaning supplies are available upon request.
- All area touched during patient treatment should be barrier wrapped. These areas should also be wiped down with Sani-cloths following the examination.
- Overgloves are available so that no paperwork or pens are touched with patient gloves.
- **Candidates should arrive with sterile instruments.** In the event candidates need sterilization procedures, an assistant will run the instruments through an ultrasonic pre cleaning unit, then autoclave them. Instruments will not be sterilized following the examination, so candidates must bring appropriate containers for carrying soiled instruments.
- A large red biohazard container is located in the sterilization area in the middle of the clinical area. There will be a small white bag with biohazard sticker at each unit for biohazard waste.

Hazardous Waste Disposal (exam-type specific):

- **Hygiene:** Procedure for disposal of blood/saliva-soaked waste.
 - A large red biohazard container is located in the sterilization area that is located in the middle of the clinical area. There will be a small white bag with biohazard sticker at each unit for biohazard waste. During cleanup, these bags should be folded down tightly, taped shut and deposited in the large red biohazard bin. The biohazard waste is only for blood soaked items. Other disposable items may be placed in the regular garbage cans.
- **Local Anesthesia:** Sharps containers are available in each operatory. With protective shield in place, remove needle from syringe and place in a paper cup. Dump paper cup in sharps container.
- **Sharps Disposal:** Red plastic sharps containers are available in each operatory. All needles, irrigation tips, broken instrument tips, etc. should be safely placed in a paper cup then emptied into the sharps container.
- **Emergency Medical Equipment:** First aid kits are located in the sterilization area and faculty room. An AED is mounted on the wall between Sterilization room and faculty room. Emergency oxygen tank and emergency kit are in the Panoramic X-Ray room. An emergency binder is on the wall outside the Panoramic X-Ray room with all necessary information. Each operatory has a medical emergency protocols binder mounted above the sink. All DSU phones need to dial an “8” for an outside line. A “911” call script is taped to the wall by each phone in the operatories. Eyewash station is in the sterilization room. Exposure protocol for needle sticks etc. is in the faculty room. Ask DSU personnel for immediate assistance.